

Z751/...

Mat.: 8.8/ 830 N/mm<sup>2</sup>  
10.9/1000 N/mm<sup>2</sup>

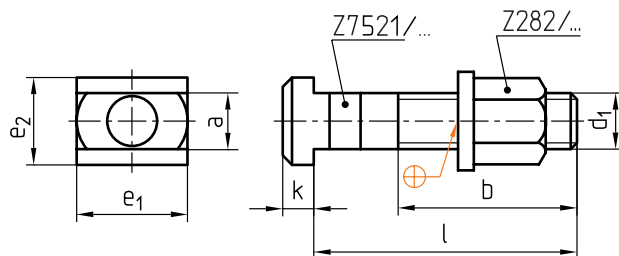
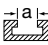

b	e <sub>1</sub> /e <sub>2</sub>	k		d <sub>1</sub>	l	Nr./No.
55	22	8	<b>14</b>	<b>M12</b>	<b>80</b>	Z751/14/12x 80
	28	10	<b>18</b>	<b>M16</b>		18/16x 80
65	35	14	<b>22</b>	<b>M20</b>	<b>100</b>	18/16x100
						22/20x100
85	44	18	<b>28</b>	<b>M24</b>	<b>125</b>	22/20x125
						28/24x125